

CHAINS

RESTORED CORNER FOR OREGON STATE BOARD OF FORESTRY

One Quarter corner common to Sections 28 and 33,
T. 2S, R. 9W, W.M., Tillamook County, Oregon.

ORIGINAL

Post (now missing) from which a:

80" Cedar bears S22E 76 lks.; now 60" hollow snag, face and scribes burnt out.

24" Hemlock bears N11E 61 lks.; now 30" stump, edges of rotted face visible.
30 lk. Creek, W, bears East 263 lks.; now in place.

RESTORED

Set 1 1/2" x 36" galvanized iron pipe with 3" bronze cap marked "OREGON STATE BOARD OF FORESTRY 1/4 S28 S33 1958 RS401", 33 inches in ground, and from which a:

8" Hemlock bears N7E 30.9 ft.; scribed 1/4 S28 BT RS 401.

12" Hemlock bears S34E 22.0 ft.; scribed 1/4 S33 BT.

Oregon State Board of Forestry metal location poster on 12" Hemlock BT.
Set 4" x 4" x 72" white painted Cedar post 1.4 feet N.W. of pipe.

Dated September 23, 1958

Restored by

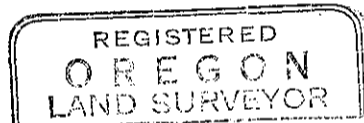

Richard A. Morris

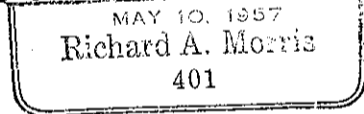

Present and witnessed by Ronald Schulson

Book I

345.

345

345